



3 COMPONENT SYSTEM

1. LOCK



2. FOREND COVER

3. STRIKER



# REVOLUTION XT

AGB MAGNETIC LOCKS WITH  
CUSTOMISABLE FACE PLATE



**Lock Type**

Euro Lock  
WC Lock



**Axis**

90 mm (Euro)  
96 mm (WC)



**Backsets**

60mm



**Material**

Zamak  
Steel



**Steel Forend**

Round End  
18 mm



**Hub**

8mm

**Description**

Magnetic flush-mounted with central latch and customisable forend in 4 finishes. The lock features no protrusion on the forend, thanks to the latch which is entirely retracted into the casing. Whilst the lock is engaged, it secures the latch which also makes it function as a bolt. In this state, the handle's movement is not restricted.

**Application**

Due to the magnetic symmetric latch, no handing is required

**Mounting**

Cut a slot and include a milled component on the panel (dimensions on pg.2). Fix the lock with two screws (3.5x20 mm).

COMPONENT 1



**WC (BATHROOM/PASSAGE)**

B01108.60.01

**1 FINISH**  
Zamak

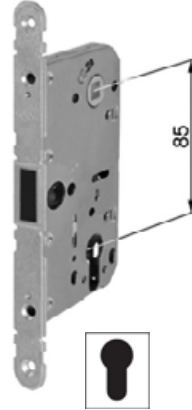

**EURO**

B01109.60.01

**1 FINISH**  
Zamak

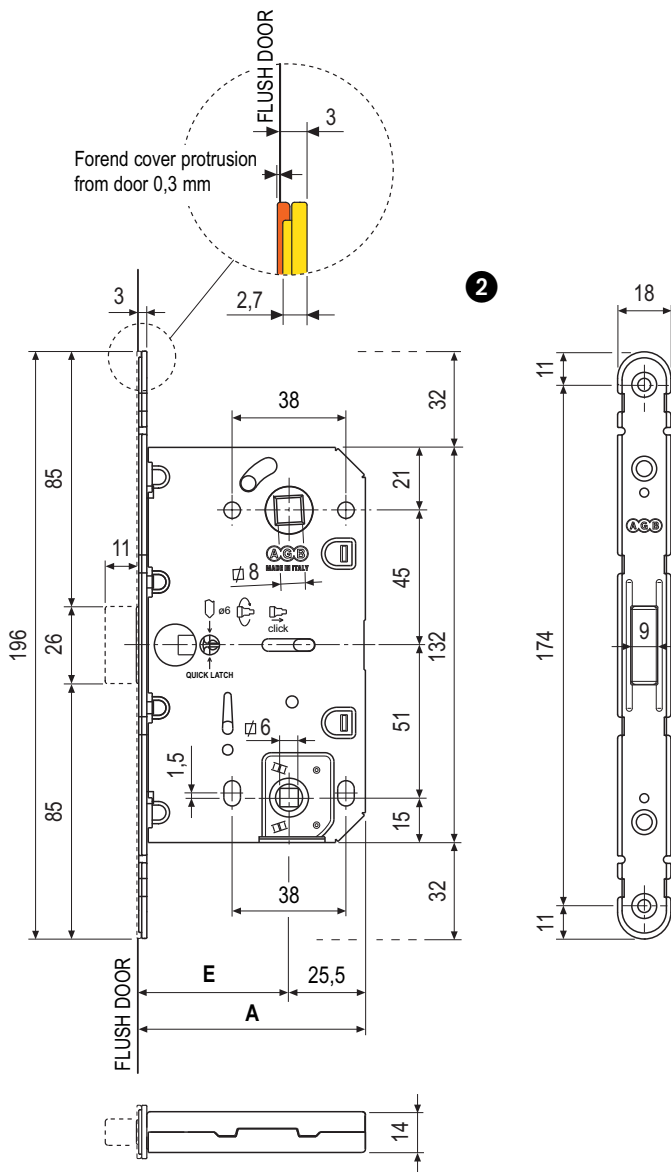

E	A
50,5	76
60,5	86
70,5	96

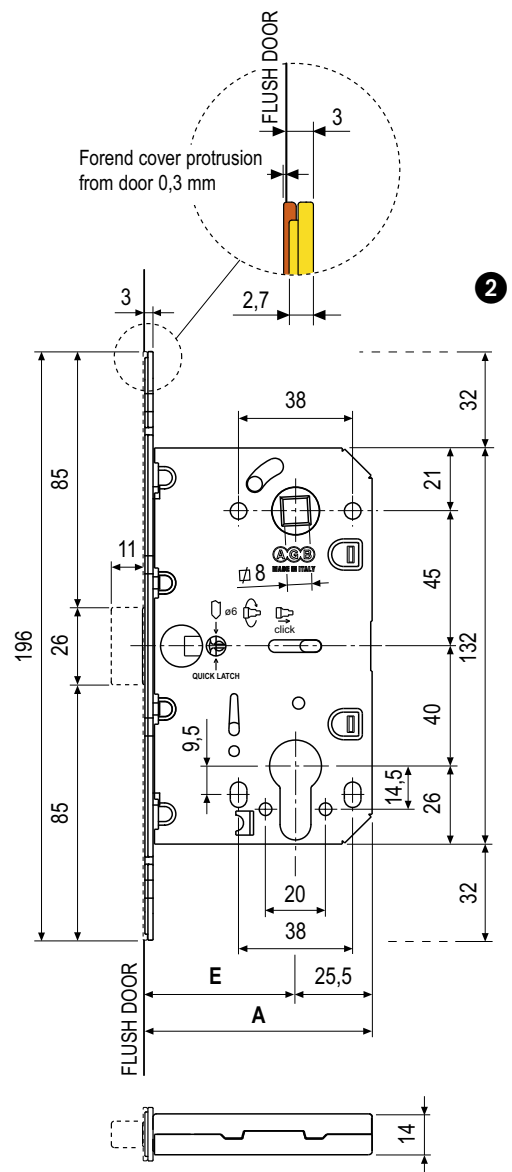

E	A
50,5	76
60,5	86
70,5	96

COMPONENT 2

Paint [01] to match door finish



01

12

FM

34

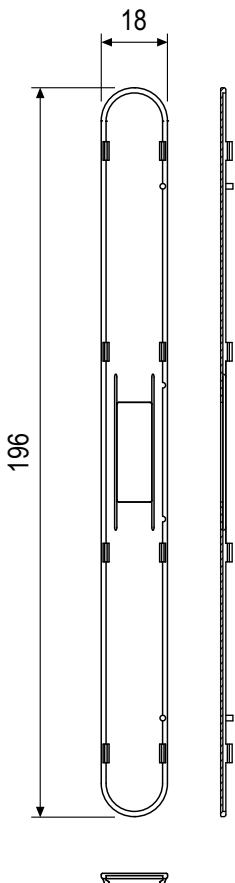





**Description**

The forend plate is customisable allowing the lock to completely blend with the door design. Thanks to the practical snap-in installation of the forend, it is possible to hide the fastening screws of the lock giving more elegance to the door.

**NOTE**

Neutral coating of the plain forend cover (B01120.00.01) can be customised with the same finishing as that of the door. No compatibility problems were found with the coats tested by AGB. AGB always advises customers to check the resistance of the coat before serial forend cover coating.

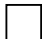
Forend Plastic Cover Plates

<b>Plain</b>		B01120.00.01
<b>Matt Chrome</b>		B01120.00.34
<b>Matt White</b>		B01120.00.FM
<b>Antique Brass</b>		B01120.00.12

COMPONENT 3

**MINIMAL PLUS XT STRIKER**

Magnetic | Adjustable



**Matt Chrome Plated**  
B02402.28.34



**White**  
B02402.28.91



**Matt Black**  
B02402.28.93

**Description**

Minimalist and linear design, it is an adjustable striker which is very discreetly installed on the door frame.

Minimal Plus XT is adjustable up to  $\pm 1,5$  side-to-side horizontally of if additional adjustment is required, you can achieve a further 1.5mm of adjustment by turning the cover tray.

**Application**

To be coupled on doors with wooden frame (rebated and flush). The slanted walls of the striker ensure match with the lock latch, for perfect closing.

**Mounting**

For mounting, use two screws (3.5x20 mm).

**MINIMAL XT STRIKER**

Magnetic | Adjustable



**Antique Brass Plated**  
B02402.05.12

\*Minimal XT striker only available in bronze.

**Description**

Striker with rounded edge. Minimalist, linear design ensures that it is practically invisible on the door frame. It can be adjusted (up to 1.5 mm) by turning the striker 180°.

**Application**

Installed onto doors with wooden frames (rebated and flush). The slanted walls of the striker ensure match with the lock latch, for perfect closing.

**Mounting**

Apply a milled component to the frame (dimensions in drawing). For mounting, use two screws (3.5x20 mm).

MINIMAL PLUS XT STRIKER

FRONT

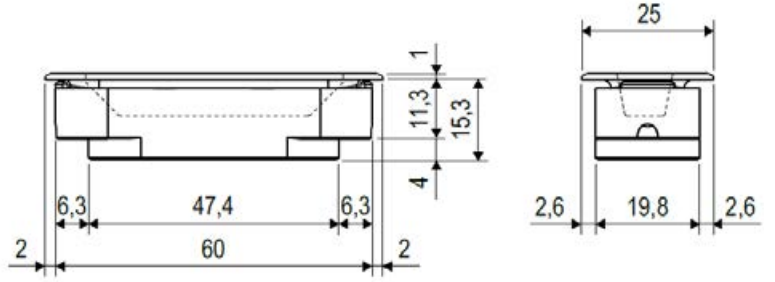
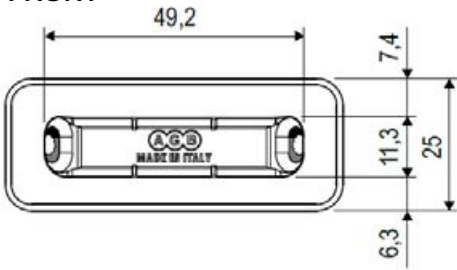

BACK

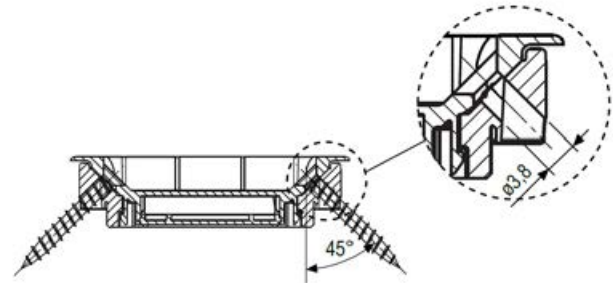
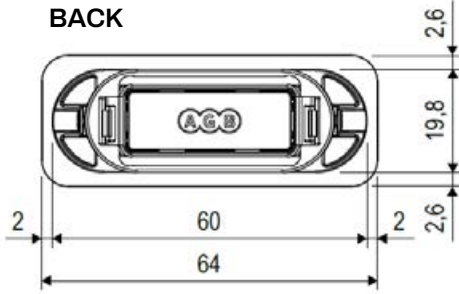

Adjustment

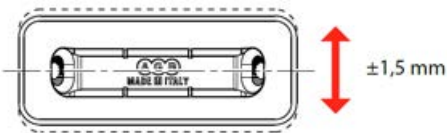

MINIMAL XT STRIKER

FRONT

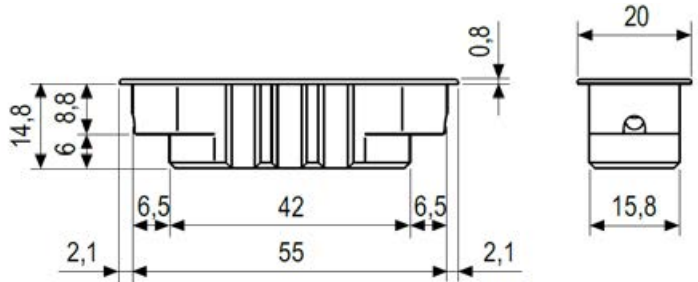
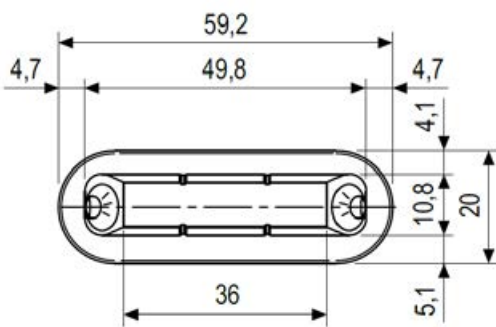

BACK

