

All information on the drawing is the property of Formani Holland B.V. and may not be copied, in any way whatsoever without obtaining the permission in writing from Formani Holland B.V.

LBIII-19P13SFC

sprung lever handle attached to plate
with metal sub-rose
stainless steel

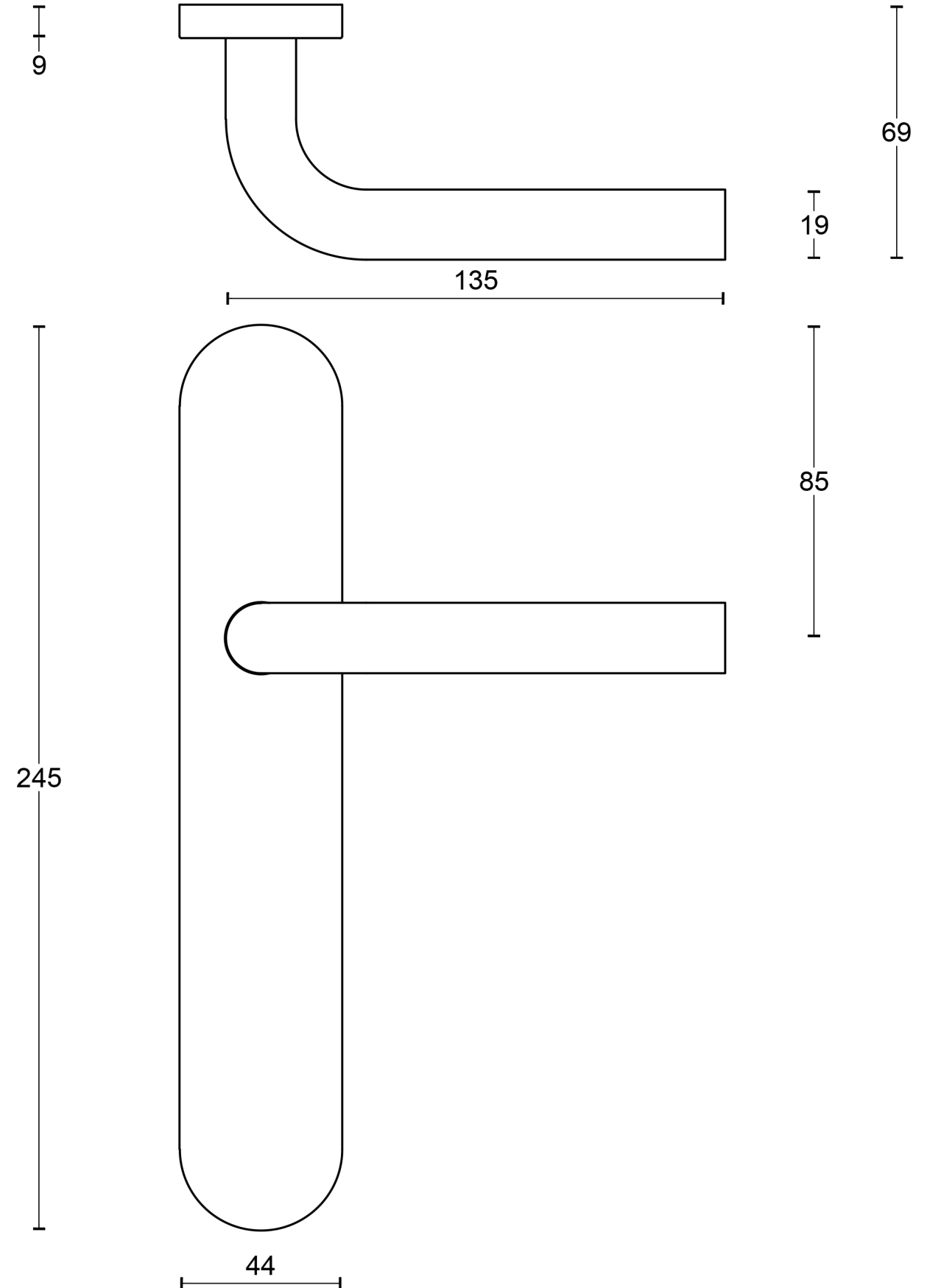
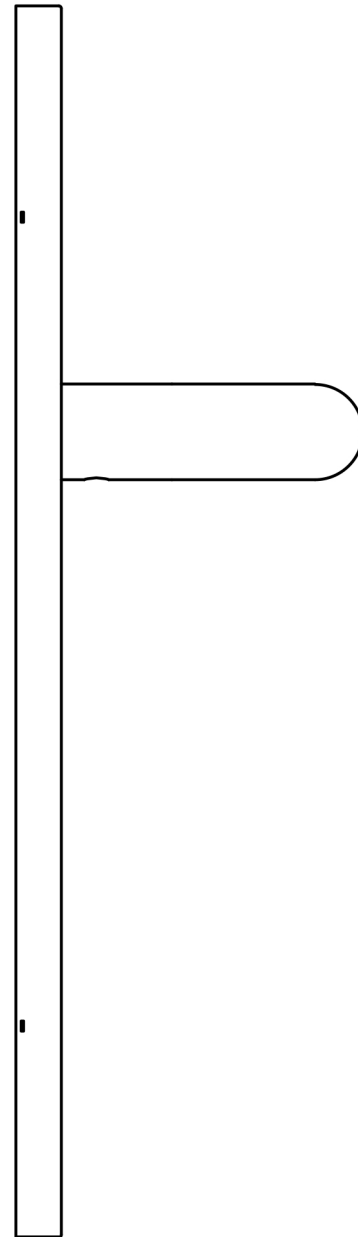
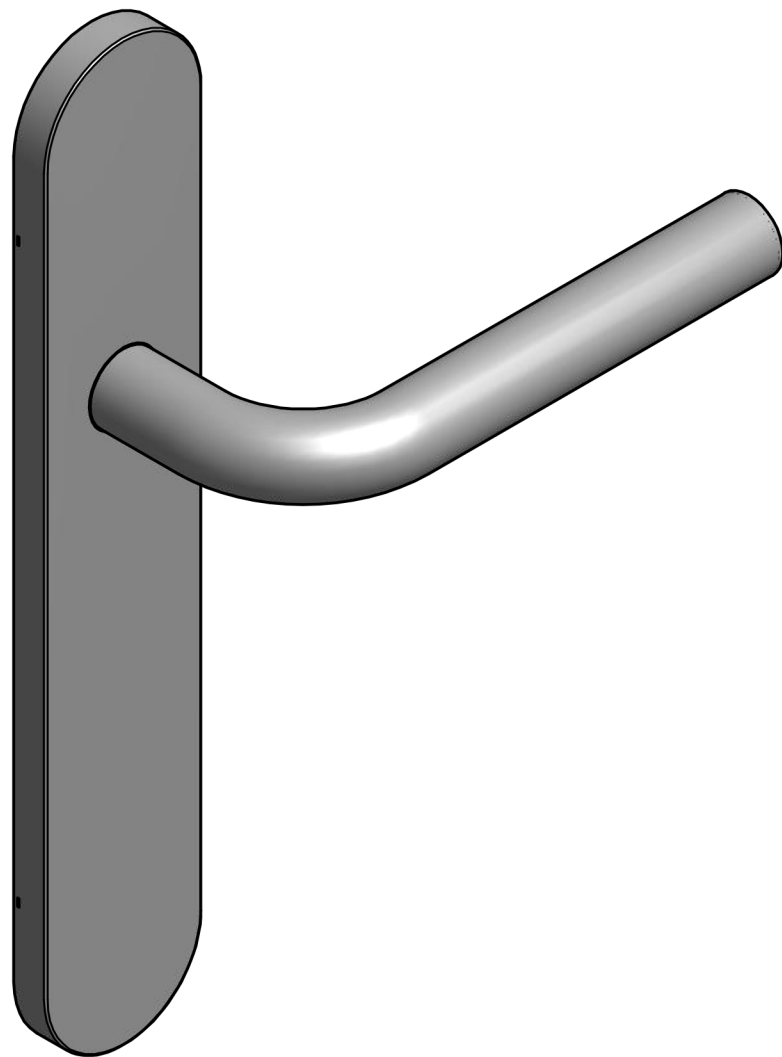

FORMANI®		Part number: 1501D044 LBIII-19P13 SFC V02	
		Description: LBIII-19P13SFC	Format: A3
Doc no.:	1501D044 LBIII-19P13 SFC V02.dwg		
Drawn by:	Christian Brimbois	Creation date:	19-8-2015
FORMANI HOLLAND B.V. EUROPALAAN 12 6199 AB MAASTRICHT-AIRPORT NL T +31 (0)43 308 90 00 INFO@FORMANI.COM FORMANI.COM			